



# Shenandoah

## Instruction Manual



720 Industrial Park Road  
Anderson, MO 64831  
800-467-6065 FAX 417-845-6069  
shenmfg.com  
Made in the U.S.A.



### FOR YOUR SAFETY

If you smell gas:

1. Open Windows
2. Don't touch electrical switches
3. Extinguish any open flame
4. Immediately call your gas supplier

### POUR VOTRE SURETE

Si vous sentez une odeur de gaz:

1. Ouvrez les fenêtres
2. Ne touchez pas aux de commutateurs électriques
3. Eteindre n'importe quelle ouverture flambe
4. Immédiatement appeler votre fournisseur de gaz

### FOR YOUR SAFETY

Do not store or use gasoline or other flammable vapors and liquids in the vicinity of this or any other appliance.

### POUR VOTRE SURETE

Pas l'essence de magasin ou usage ou les autres vapeurs et les liquides inflammables à proximité de cet ou l'autre appareil.

**Note:** The original, authoritative version of this manual is the English version produced by CTB, Inc. or any of its subsidiaries or divisions, (hereafter collectively referred to as "CTB"). Subsequent changes to any manual made by any third party have not been reviewed nor authenticated by CTB. Such changes may include, but are not limited to, translation into languages other than English, and additions to or deletions from the original content. CTB disclaims responsibility for any and all damages, injuries, warranty claims and/or any other claims associated with such changes, inasmuch as such changes result in content that is different from the authoritative CTB-published English version of the manual. For current product installation and operation information, please contact the customer service and/or technical service departments of the appropriate CTB subsidiary or division. Should you observe any questionable content in any manual, please notify CTB immediately in writing to: CTB Legal Department, P.O. Box 2000, Milford, IN 46542-2000 USA.

















## **DANGER !**

**SICKNESS AND/OR DEATH MAY RESULT FROM USE OF THIS HEATER IN AN UNVENTILATED BUILDING OR IN HUMAN LIVING AREAS.**

**LE RESULTAT DE MAI DE MORT DE ET/OU DE MALADIE DE L'USAGE DE CET APPAREIL DE CHAUFFAGE DANS UN CONSTRUISANT UNVENTILATED OU DANS L'HUMAIN SECTEURS VIVANTES.**

**EL USO DE ESTA CALENTADORA EN UN UNVENTILATED CONSTRUYENDO O EN HUMANO AREAS PUEDE RESULTAR EN ENFERMEDAD Y/O MUERTE**

- |   |   |
|---|---|
| <p> Do not use the heater to heat human living areas. The intended use of the heater is to provide warmth for poultry and hog buildings. Adequate ventilation must be provided.</p>   | <p> Ne pas utiliser l'appareil de chauffage pour chauffer humain habiter les secteurs. L'usage voulu de l'appareil de chauffage sera obligé à fournir la chaleur pour les bâtiments de volaille et cochon. La ventilation suffisante doit être fournie.</p>  |
| <p> Use only the type of gas being supplied to the unit as marked on it (Propane or Natural Gas). Do not operate with improper fuel. Ventilation air and combustion air must not be obstructed.</p>   | <p> Utiliser seulement le type de gaz étant fourni à l'unité comme marqué dessus (le Propane ou le Gaz Naturel). Ne pas fonctionner avec le carburant déplacé. L'air de ventilation et l'air de combustion ne doivent pas être encombrés.</p>  |
| <p> Test all pipe and pipe joints for leaks by a suitable means (Example: soap and water solution or a pressure check). Do not operate the heater until this test has been preformed.</p>   | <p> Essayer tous joints de tuyau et tuyau pour les fuites par un moyens convenables (l'Exemple : la solution de savon et eau ou un contrôle de pression). Ne pas fonctionner l'appareil de chauffage jusqu'à ce que ce test a été préformé.</p>  |
| <p> Do not move, handle, repair, or adjust height of the heater while in operation or when still hot. Do not bypass any safety devices.</p>   | <p> Pas le mouvement, la poignée, la réparation, ou ajuster la hauteur de l'appareil de chauffage pendant que dans l'opération ou quand calme chaud. Ne pas sauter d'appareils de sûreté.</p>  |
| <p> Before each use, a visual inspection of the heater is essential to insure safe and satisfactory heating. Replace or repair defective components before operating heater. Failure to do so will void warranty and could result in injury or property damage.</p> | <p> Avant que chaque usage, une inspection visuelle de l'appareil de chauffage est essentielle pour assurer le chauffage sûr et satisfaisant. Remplacer ou réparer des composants le défectueux avant de fonctionner appareil de chauffage. L'échec pour ainsi faire annulera la garantie et pourrait avoir pour résultat les dommages de blessure ou propriété.</p> |
| <p> The installation of these appliances is to be in accordance with CAN/CGA-B149.1 and National Fuel Gas Code, ANSI 2223.1/NFPA 54 installation codes for gas burning appliances and equipment and/or local codes.</p>   | <p> L'installation de ces appareils sera obligé à être conformément à CAN/CGA-B149.1 et Code de Gaz de Carburant National, ANSI 2223.1/NFPA 54 codes d'installation pour le gaz appareils ardents et et/ou d'équipement codes locaux.</p>  |
| <p> <b>WARNING:</b> Improper installation, adjustment, alteration, service or maintenance can cause property damage, injury or death. Read the installation, operating and maintenance instructions thoroughly before installing or servicing this equipment.</p>   | <p> <b>L'AVERTISSEMENT :</b> l'installation Déplacée, l'ajustement, le changement, le service ou l'entretien peuvent causer les dommages de propriété, la blessure ou la mort. Lire l'installation, fonctionnant et les instructions d'entretien à fond avant d'installer ou entretenir cet équipement.</p>  |

**DSI UNITS MUST BE PROPERLY GROUNDED. DO NOT ALTER ELECTRICAL CORD.**

**LES UNITES DE DSI DOIVENT ETRE CONVENABLEMENT FONDE. Ne PAS CHANGER LA CORDE ELECTRIQUE.**

**Las UNIDADES de DSI se DEBEN MOLER APROPIADAMENTE. No ALTERE CUERDA ELECTRICA.**

Plug in the three-prong power cord to a correctly grounded three-prong electrical outlet.

# SPACE HEATER MANUAL

The installation of these appliances is to be in accordance with CAN/CGA-B149.1 and National Fuel Gas Code, ANSI Z223.1/NFPA 54 installation codes for gas burning appliances and equipment and/or local codes.

If you smell gas:

1. Open Windows
2. Don't touch electrical switches
3. Extinguish any open flame
4. Exit the building
5. Immediately call your gas supplier

Do not store or use gasoline or other flammable vapors and liquids in the vicinity of this or any other appliance.

**⚠ WARNING:** Improper installation, adjustment, alteration, service or maintenance can cause property damage, injury or death. Read the installation, operating and maintenance instructions thoroughly before installing or servicing this equipment.



**DANGER:** Sickness and/or death due to asphyxiation if this space heater is used in an unventilated building or living area, such as a home, shop for human habitation, or recreational vehicle.

Installation of this heater in a home, shop or recreational vehicle may result in fire or explosion, property damage or loss of life.

**⚠ WARNING:**

Proper gas supply pressure must be provided to the inlet of the appliance. Refer to the rating plate for proper gas supply pressure. Gas pressure in excess of the maximum inlet pressure specified at the appliance inlet can cause fires or explosions, leading to serious injury, death, building damage, or loss of livestock.

**⚠ WARNING:** Use only the type of gas being supplied to the unit as marked on unit (Natural or LP). Do not operate with improper fuel.

**⚠ WARNING:** Do not expose unit to rain, or electrical shock hazard may result. This space heater is designed for indoor use only.

**⚠ WARNING:** This heater must not be washed. Use of a pressure washer, water or liquid cleaning solution on this heater can cause severe personal injury or property damage due to water and/or cleaning solution:

A. In electrical components, connections and wires causing shock or component failure.

B. On gas control components causing corrosion which can result in gas leaks and fire or explosion from the leak. Heater must be cleaned without being subjected to liquid spray or excessive wetting.

**⚠ WARNING:** Adequate ventilation must be provided. Ventilation air and combustion air must not be obstructed. Do not place this space heater in close proximity of intake and/or discharge ductwork. This could cause equipment to produce an excessive amount of combustion, by-products and/or cause overheating conditions or malfunction.

**⚠ WARNING:** This space heater is equipped with a three-prong grounded plug. For your safety against shock, this should only be used in a properly grounded three-prong receptacle outlet. The use of the extension cords to supply power to the Space Heater is not recommended.

**⚠ WARNING:** Test all pipe and pipe joints for leaks by a suitable means (Example: soap and water solution or a pressure check). Do not attempt to operate this space heater until this test has been performed.

**⚠ WARNING:** Do not repair, handle, move, or adjust height of the space heater while in operation or when still hot.

**⚠ WARNING:** Do not bypass any safety devices. Replace or repair defective component before operating the space heater. Failure to do so will void warranty and could result in injury or property damage.

## SPECIFICATIONS

	<u>LP</u>	<u>NAT</u>
Input BTU/hr	250,000	250,000
Inlet Pressure	11" w.c.	7" w.c.
Burner Manifold Pressure	9" w.c.	4 1/2" w.c.
Electrical v/hz/a	110 V 60 HZ 115/60/5.5 230/50/5.5 230/60/5.5	
Motor	Thermal protected 1/3 H.P.	
Heated air output	900 C.F.M.	
Unit Switch	On-Off Toggle	
High temp safety	Manual reset limit switch	
Air flow safety	Wind vane sail switch	
Gas flow safety	Automatic gas shut off control with flame sensing rod	
Power cord	6' wire power cord with molded plug	
Thermostat Control	Remote thermostat or computer control system*	
Dimensions (L x W x H)	24 3/4" x 19 1/4" x 29 1/4"	
Net weight	116 lbs. w/kit	52.73 KG
	108 lbs. w/o kit	49.09 KG
Shipping weight	123 lbs. w/kit	55.35 KG
	115 lbs. w/o kit	51.75 KG

### Clearances

20" from sides, back, top, bottom, to any roof, floor, or side walls of building. Allow a minimum of 10 feet to discharge air outlet.

\* *Not included in Standard Unit*

*Note - Refer to price sheet for standard features, accessories, and options.*

1. Read all safety precautions in this owner's manual.
2. Do not allow the Space Heater to come closer than 20 inches from sides, back, top, bottom, to any roof, floor, or side walls of building. Allow a minimum of 10 feet to discharge air outlet.
3. If the Space Heater is suspended by chains in a fixed position, be sure the chains are rated for the weight of the Space Heater.
4. If height adjustment is desired, the Space Heater can be mounted on a cable suspension system operated by a winch. Attach the properly weight-rated cable to the four S Hooks at the top of the Space Heater. Be sure to install a safety device to keep the Space Heater from being accidentally lowered too close to the floor. Also, be sure to add a stop in the winching system to protect the unit from being winched up too high; therefore, being too close to the ceiling of the building.
5. The Space Heater should be level and not to exceed a 5 degree incline.
6. Install a gas pipe trap to the gas pipe inlet on the Space Heater.
7. We recommend that high-pressure lines and regulators be outside of house.
- 8a. For: LP Gas pressure requirements, if the supply pressure to the Space Heater is greater than 11" w.c., a secondary regulator will need to be installed.  
**Caution:** Do not exceed maximum rated pressure to the secondary regulator. Note: the pressure on the outlet of the gas valve should be 9" w.c.
- 8b. For: Natural Gas pressure requirements, if the supply pressure to the Space Heater is greater than 7" w.c., a secondary regulator will need to be installed.  
**Caution:** Do not exceed maximum rated pressure to the secondary regulator. Note: the pressure on the outlet of the gas valve should be 4 1/2" w.c.

9. Make the last connection of the flexible hose to the supply pipe and turn on the gas supply. Use a good grade of pipe dope compound on all gas pipe connections.

10. Check for gas leaks ( use a 50/50 soap and water solution or a pressure check). This is very important. **DO NOT** operate the Space Heater if there are any gas leaks.



11. Assemble air deflector with the flaps pointing vertically and place it on the air discharge opening with screw supplied.

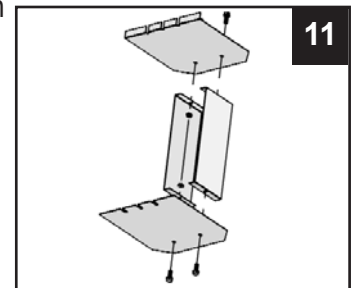

12. When connecting the Space Heater directly to thermostat or a whole house system, check the wiring diagram of that type of controller for proper wiring to insure safe operation of the Space Heater, if any difficulty arises, call your dealer. Turn the thermostat dial to a temperature lower than the temperature of the building.
13. Plug in the three-prong power cord to a correctly grounded three-prong electrical outlet. **DO NOT** use any electrical extension cords to supply power.

# SPACE HEATER GAS PIPING AND MINIMUM CLEARANCES

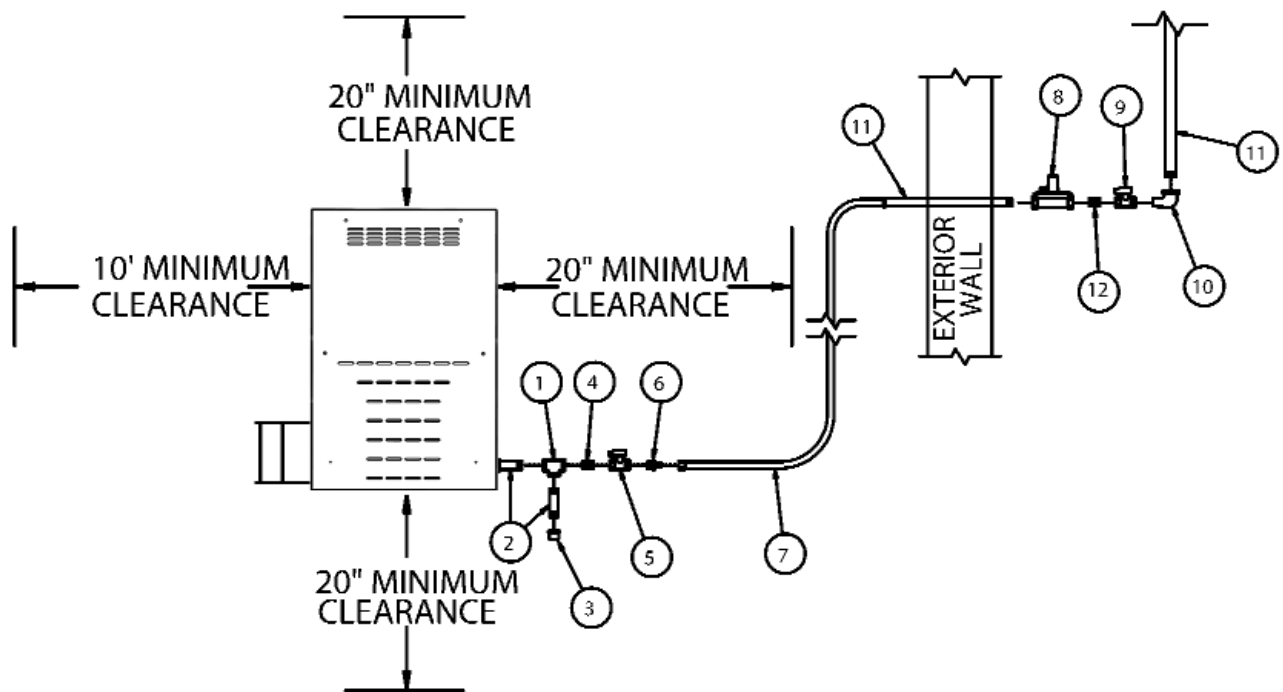

NO.	DESCRIPTION	PART NO.
1	PIPE TEE 1/2" X 1/2" X 1/2"	13005255
2	PIPE NPL 1/2" X 3"	13005193
3	PIPE CAP 1/2"	13005229
4	PIPE NPL 1/2" CLOSE	13005228
5	VALVE BALL COCK 1/2"	13004937
6	HOSE NPL	13005180
7	HOSE 8'	13008098
8	REGULATOR LV4403 B4 LP	13005203
	REGULATOR 325-3 NAT	13005074
9	VALVE BALL COCK 1/2"	SUPPLIED BY INSTALLER
10	PIPE STREET ELBOW 1/2"	
11	HARD PIPING	
12	PIPE NPL 1/2" CLOSE	

PARTS #1-8 ARE INCLUDED IN OPTIONAL ACCESSORY KIT

## OPERATING INSTRUCTIONS

1. Read all instructions in this owner's manual before operating the Space Heater.
2. Recheck the type of gas being supplied to the unit. Make sure it is the same gas for which the Space Heater and orifice is adjusted.
3. Double check for any gas leaks ( see Safety Precautions). This is very important. Do not operate this heater until there are no gas leaks.
4. Turn on all gas valves to the Space Heater.
5. Turn the system switch to the ON position. This is located on the outside of the heater near where the power cord enters the case.
6. After flame is established, allow unit to run for a couple of minutes. Then make the Space Heater go through several "start-ups and shut downs" to check the operation of the unit.
7. Set the thermostat or system control to desired house temperature.

**Note:** When the Space Heater has not been used for an extended length of time due to off season or between flocks, follow the maintenance instructions before restarting the heater. Then follow regular operation instructions.

## SHUT DOWN INSTRUCTIONS

1. Turn systems switch to the off position.
2. Turn off the gas valve between gas hose and supply pipe.
3. Turn off the gas supply valve at supply source.
4. Unplug the power cord.

## MAINTENANCE INSTRUCTIONS

1. Turn off gas supply and disconnect electrical supply from unit before any type of work or cleaning is done.
2. Do not use any cleaning solvents and/or liquids of any type to clean the Space Heater. Use only compressed air to clean the Space Heater.
3. Pay close attention to the dirt and dust build up on the concave side of blades on the blower wheel. This is very important. A dirty wheel will reduce the air flow output and could cause the wheel to become out of balance thus causing premature failure.
4. Clean out control box with compressed air between flock and annually. Dust-build up could cause electrical shorts, reduce wiring life, and require higher maintenance.
5. Check all electrical wiring and cords for loose connections or frayed wires. Tighten, repair, or replace any damaged parts.
6. Check all gas hoses and piping frequently. Be sure the hose is not cut, weathered, cracked or worn. Inspect all gas piping and check for leaks (see Safety Precautions). This is very important as gas leaks should be watched for and corrected. Also, clean out the pipe trap of water, line scale, and/or rust.
7. Keep the main burner orifice clean and free from carbon build-up, dust, and debris. Also, inspect around the air inlet of the burner and keep clean. This will help the Space Heater run more efficiently
8. Check the wind sail switch for proper operation. Pay close attention to the travel of the sail switch arm and make sure it is not restricted. Occasionally, clean dust build up off of sail part of wind switch. This is necessary.
9. Check the chains or cable holding the unit for safety.
10. If the remote thermostat is used, be sure to keep the coil clean.
11. Turn on the Space Heater and allow it to cycle several times at the beginning of each heating season or between flocks of birds to insure the Space Heater is running properly.
12. An annual inspection by a qualified service person is recommended.

# TROUBLE SHOOTING GUIDE

The LED light located in the module cover can help isolate where a problem might be located.

**THE LED LIGHT WILL FLASH FROM 1 TO 4 TIMES AFTER THE MODULE LOCKS OUT DUE TO FAULTY OPERATION.**

1. LED blinks, fan runs, heater lights ----- Normal operation

**IF THERE IS A PROBLEM THE:**

2. LED does not blink when the unit ----- No voltage to heater from thermostat  
 is turned on, fan does not run, ----- 24 volts not supplied from transformer to thermostat  
 heater does not light

3. LED flashing:

1 time ----- Sail switch is stuck, closed, or shorted out  
 2 times ----- Sail switch flapper stuck to base of blower housing with debris  
 ----- Sail switch doesn't close or is defective  
 ----- Fan wheel binding or dirty  
 ----- Bad motor, capacitor or wiring  
 ----- High limit switch tripped or defective

3 times ----- No fuel  
 ----- Broken or disconnected ignitor  
 ----- Defective improperly positioned, dirty, or disconnected flame sensor  
 ----- Bad valve or wires connected to valve

4 times ----- Bad HSI board

	<b>Possible Cause</b>	<b>Corrective Action</b>
Problem 1) ----- Blower Will Not Run	a. No power to heater ----- b. System switch to "off" c. Defective motor d. Bad capacitor	a. Check electric supply b. Turn switch to "on" c. Replace the motor d. Replace capacitor
Problem 2)----- Sail Switch Does Not Close	a. Bad sail switch----- b. Low air flow c. Obstruction or bent sail arm  d. Loose or broken wire	a. Replace sail switch b. Clean blower and refer to problem #1 c. Remove obstruction or straighten arm d. Repair or replace wire
Problem 3) ----- High Limit Switch Open (Reset limit switch after Problem corrected)	a. Manifold pressure to high----- b. Blower wheel loose or damaged c. Blower wheel dirty d. Motor turns too slow e. Wrong burner orifice f. Wrong type of gas g. Blockage on inlet or outlet h. Defective limit switch	a. Check pressure and adjust as required b. Tighten or replace blower wheel c. Clean blower wheel d. Replace motor or refer to Problem #1 or 2 e. Replace orifice with correct one f. Check the gas g. Clean and remove blockage h. Replace limit switch
Problem 4) ----- Burner lights will not stay lit	a. Flame sensor not completely in----- flame b. Defective flame sensor c. Flame sensor circuit not complete d. Blockage around base of burner e. Manifold pressure to low or to high	a. Adjust flame sensor into flame  b. Replace c. Check for loose connection and repair d. Clean out carbon or debris e. Check pressure and adjust as required
Problem 5) ----- Burner does not light	a. Ignitor broken----- b. Ignitor not in adjustment c. Ignitor not making complete circuit d. Air in gas line e. No gas	a. Replace ignitor b. Re-adjust the ignitor c. Check wiring and connections d. Purge gas line e. Refill LP tank or check natural gas supply
Problem 6)----- Unit won't heat	a. Gas supply pipe to small ----- b. Blockage in gas pipe	a. Replace with larger pipe b. Clean out trap and check gas lines
Problem 7)----- Main Burner does not shut off	a. Defective gas valve----- b. Gas pressure too high c. Defective thermostat	a. Replace the valve b. Check gas manifold pressure c. Replace the thermostat

# SPACE HEATER DSI WIRING DIAGRAM

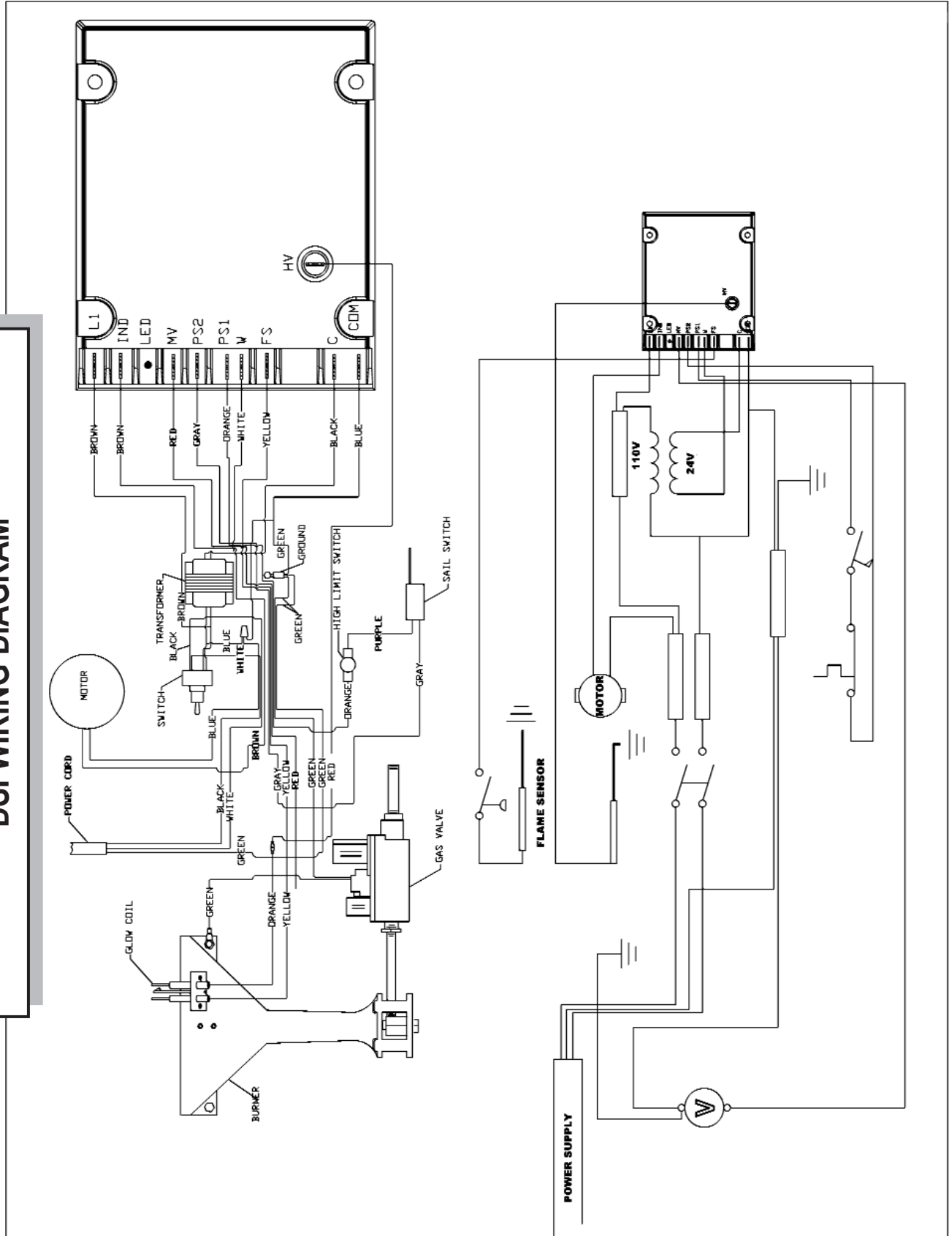

# SPACE HEATER HSI WIRING DIAGRAM

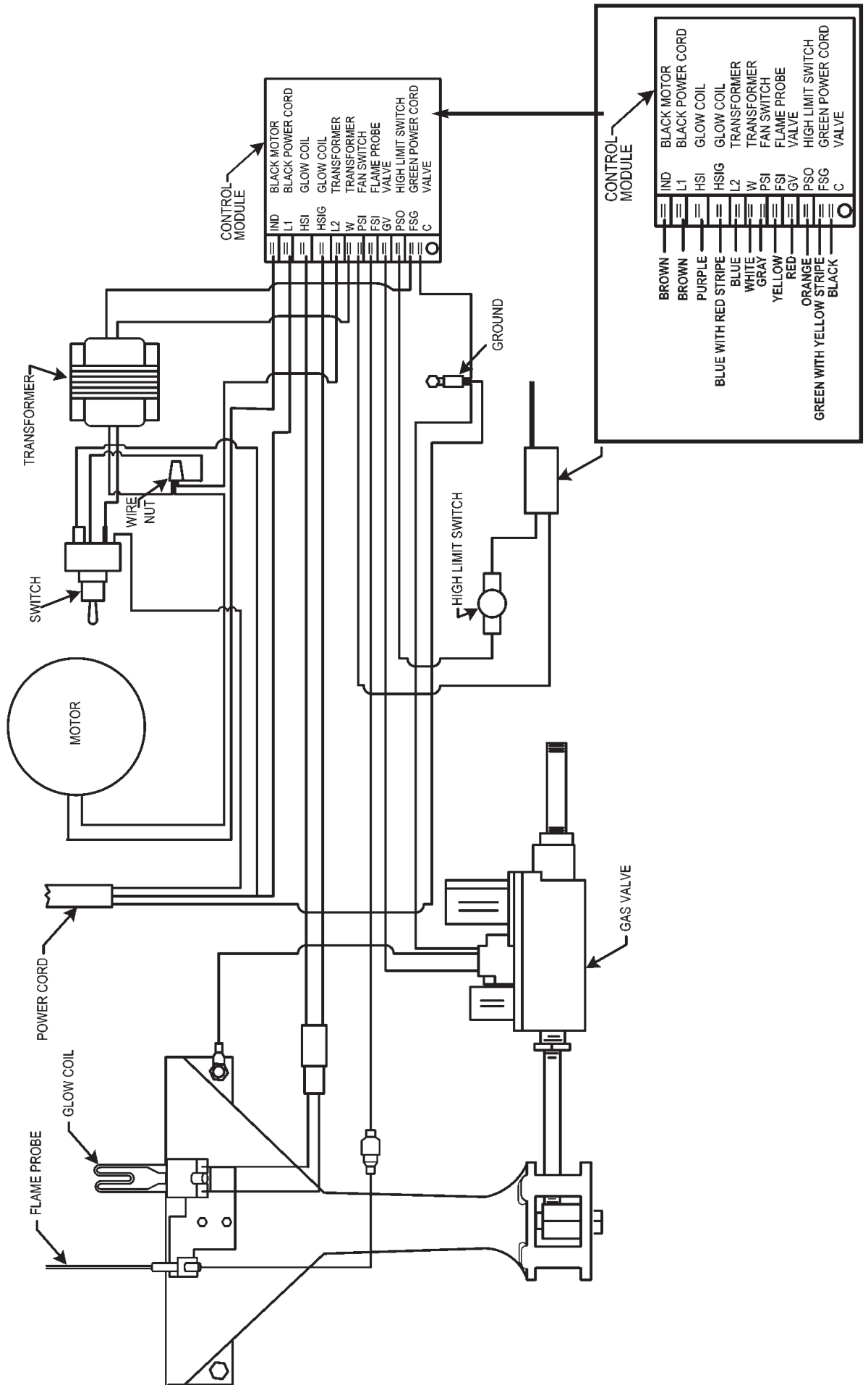

# HSI / DSI SPACE HEATER EXPLODED VIEW

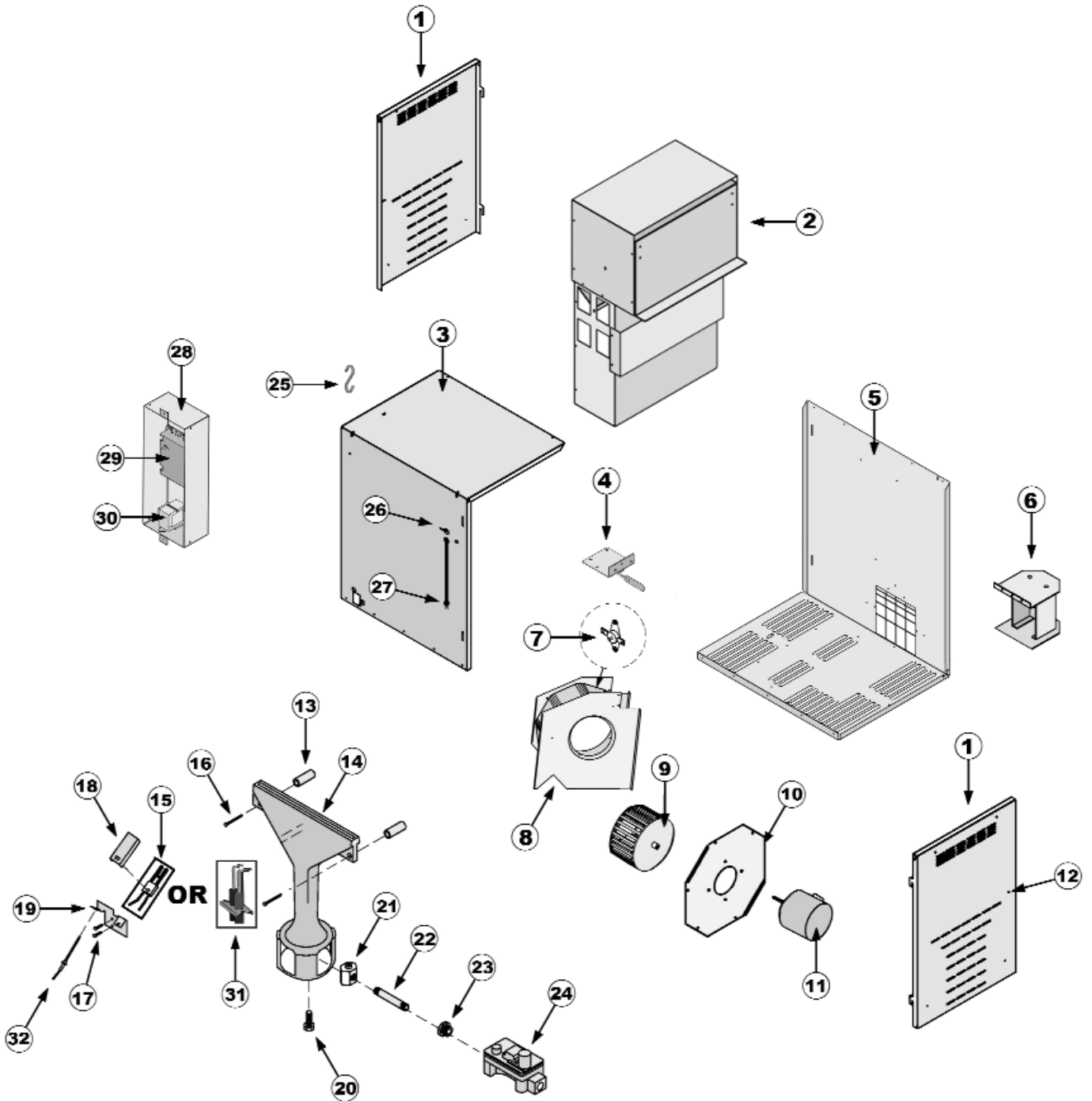

# HSI / DSI SPACE HEATER

ILLUSTRATION NUMBER	PART NUMBER	DESCRIPTION	REQUIRED NUMBER
1	23006000	DOOR RIGHT/LEFT F/SPACE	2
2	33024958	TURBO COMBUSTION CHAMBER	1
3	23005000	CABINET TOP/BACK F/SPACE	1
4	33014925	TURBO 2 FAN SWITCH/BRKT	1
5	23105010	CABINET BTM/FRONT F/ SP	1
6	33002900	EXHAUST AIR KIT	1
7	13004938	SWITCH 2450 THERMO	1
8	16550021	TURBO 250 FAN HOUSING ASM	1
9	16050006	FAN SQUIRREL CAGE 6" 1/2" BORE/GALV	1
10	23305030	MNT PLATE F/SPACE HTR	1
11	11000067	MOTOR 1/3 HP 110-230V/	1
	13000067	MOTOR TURBO FAN 230V/5	-
12	13008075	LATCH DOOR 93-225	2
13	22000005	SPACER 1/8 X 1 1/4	1
14	13005210	BURNER CAST IRON	1
15	13008086	IGNITOR GLO COIL 220 VOLT	1
	13008085	IGNITOR GLO COIL 110 VOLT	
16	16000064	SCREW #12 X 2 1/2 HEX T	2
17	13005235	SCREW 8 X 1/2 TEK	2
18	23004043	COVER HOT SURFACE IGNITOR	1
19	23014958	BRKT IGNITOR TURBO-2	1
20	13005270	BOLT 3/8 - 16 X 3/4	1
21	16050015	ORIFICE #8 LP	1
	13006224	ORIFICE .330" NAT	-
	33156223	ORIFICE .188" LP <b>EXPORT</b>	
22	13007072	PIPE NPL 1/4 X 4 3/4 B	1
23	13002747	BSHG 1/2 X 1/4 HEX BLK	1
24	13006223	VALVE WR 36E LP 9"	1
25	11004900	HOOK S LARGE	4
26	13005283	SWITCH TOGGLE DOUBLE	1
27	16-61225	CORD: SJT W/PLUG-FG 18	1
28	23007000	CONTROL BOX F/ SPACE H	1
29	13008094	MODULE IGNITION <b>HSI</b> 240 VOLT	1
	13008074	MODULE IGNITION HSI 120 VOLT	1
	16-101141	BOARD: CTRL IGN <b>DSI</b> SH	-
30	13004931	TRANSFORMER 40VA 240/2 <b>HSI</b>	1
	13004932	TRANSFORMER 40VA 120/2 <b>DSI</b>	-
31	16-101293	IGNITOR: DSI	1
32	13014929	FLAME SENSOR / .187 MA	1
	33007003	TURBO CTRL BOX COMP <b>HSI</b>	
	33007001	TURBO CONTROL BOX COMP <b>DSI</b>	
	16550022	TURBO 250 GAS VALVE ASM <b>LP</b>	
	16550023	TURBO 250 GAS VALVE ASM <b>NAT</b>	
	33156223	TURBO 2000 GAS VALVE ASM <b>EXPORT</b>	





## WARRANTY

**Agile Mfg., Inc.**, ("Agile"), warrants each new SHENANDOAH® product manufactured by it to be free from defects in material or workmanship for one (1) year from and after the date of initial installation by or for the original purchaser. If such a defect is found by the Manufacturer to exist within the one-year period, the Manufacturer will, at its option, (a) repair or replace such product free of charge, F.O.B. the factory of manufacture, or (b) refund to the original purchaser the original purchase price, in lieu of such repair or replacement. Labor costs associated with the replacement or repair of the product are not covered by the Manufacturer. The Manufacturer shall not be responsible for the costs of removal or reinstallation of products and shall not be responsible for transportation costs. The purchaser must first contact the seller to resolve product issues covered under this Warranty. If the purchaser is unable to resolve warranty claims directly with the seller, the purchaser should contact the manufacturer as the address listed below.

### Conditions and Limitations

1. The product must be installed and operated in accordance with the instruction published by the Manufacturer **or Warranty will be void.**
2. The product must be installed according to all applicable federal, State and local codes or regulations **or Warranty will be void.**
3. Warranty is **void if all components** of the product or system are not original equipment supplied by the Manufacturer.
4. This product must be purchased from and installed by an authorized distributor or certified representative thereof **or the Warranty will be void.**
5. Malfunctions or failure resulting from misuse, abuse, negligence, alteration, accident, of lack of proper maintenance, or from lightning strikes, electrical power surges or interruption of electricity, shall not be considered defects under the Warranty.
6. This Warranty applies only to systems for the care of poultry and livestock. Other applications in industry or commerce are not covered by this Warranty.

The Manufacturer shall not be liable for any **Consequential or Special Damage** which any purchaser may suffer or claim to suffer as a result of any defect in the product. "**Consequential**" or "**Special Damages**" as used herein include, but are not limited to, lost or damaged products or goods, costs of transportation, lost sales, lost orders, lost income, increased overhead, labor and incidental costs and operational inefficiencies. THIS WARRANTY CONSTITUTES THE MANUFACTURER'S ENTIRE AND SOLE WARRANTY AND THE MANUFACTURER EXPRESSLY DISCLAIMS ANY AND ALL OTHER WARRANTIES, INCLUDING, BUT NOT LIMITED TO, EXPRESS AND IMPLIED WARRANTIES AS TO MERCHANTABILITY, FITNESS FOR PARTICULAR PURPOSES SOLD AND DESCRIPTION OR QUALITY OF THE PRODUCT FURNISHED HEREUNDER.

Agile Distributors are not authorized to modify or extend the terms and conditions of this Warranty in any manner or to offer or grant any other warranties for Agile products in addition to those terms expressly stated above. An officer of Agile must authorize any exceptions to this Warranty in writing. The Manufacturer reserves the right to change models and specifications at any time without notice or obligation to improve previous models.

Agile Mfg., Inc.  
720 Industrial Park Road, Anderson, MO 64831 U.S.A.  
Phone (417) 845-6065 Fax (417) 845-6069 agilemfg.net

Effective 3/04